

Querprofil 1 1:20

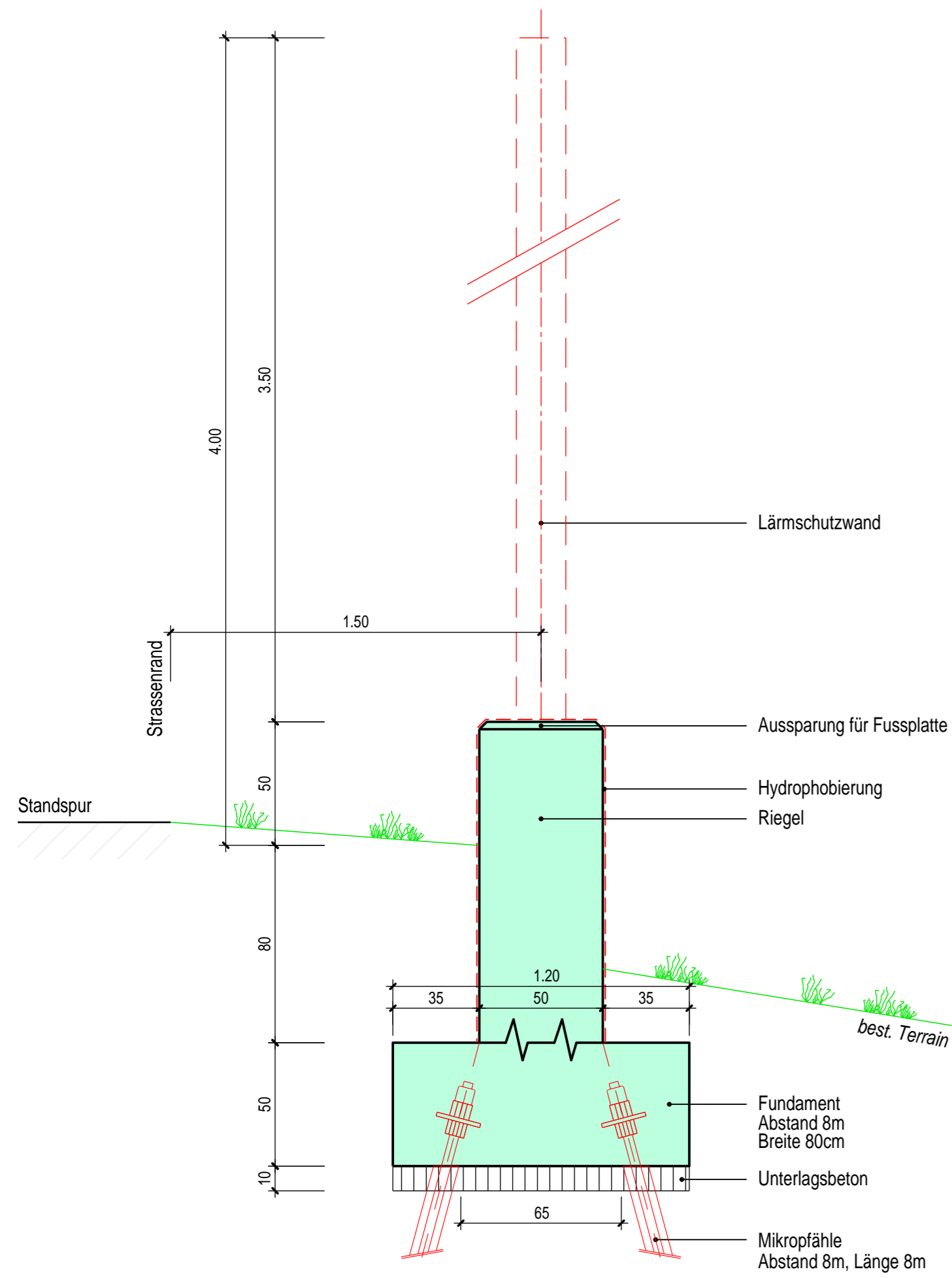

Querprofil 2 1:20

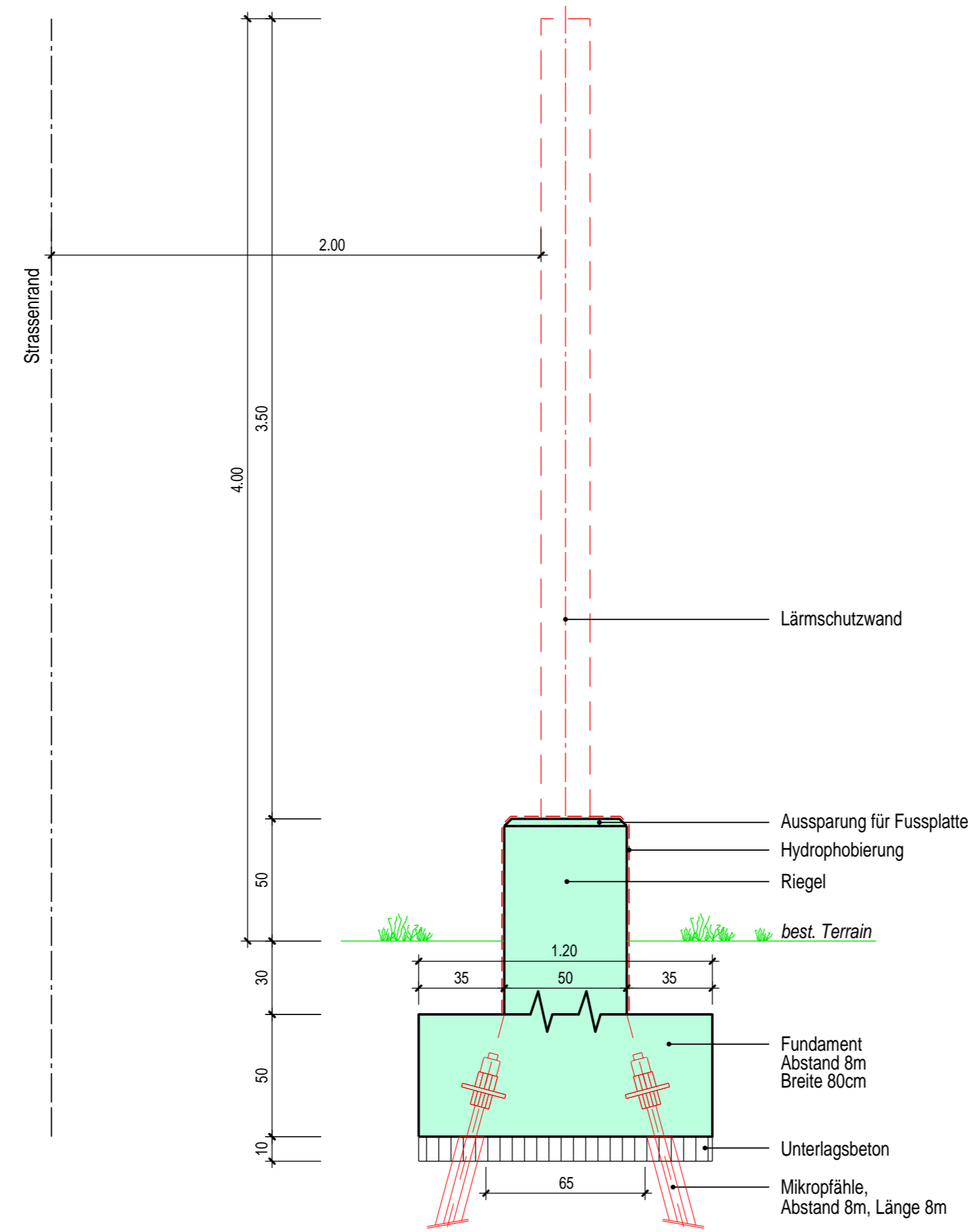

Querprofil 3 1:20

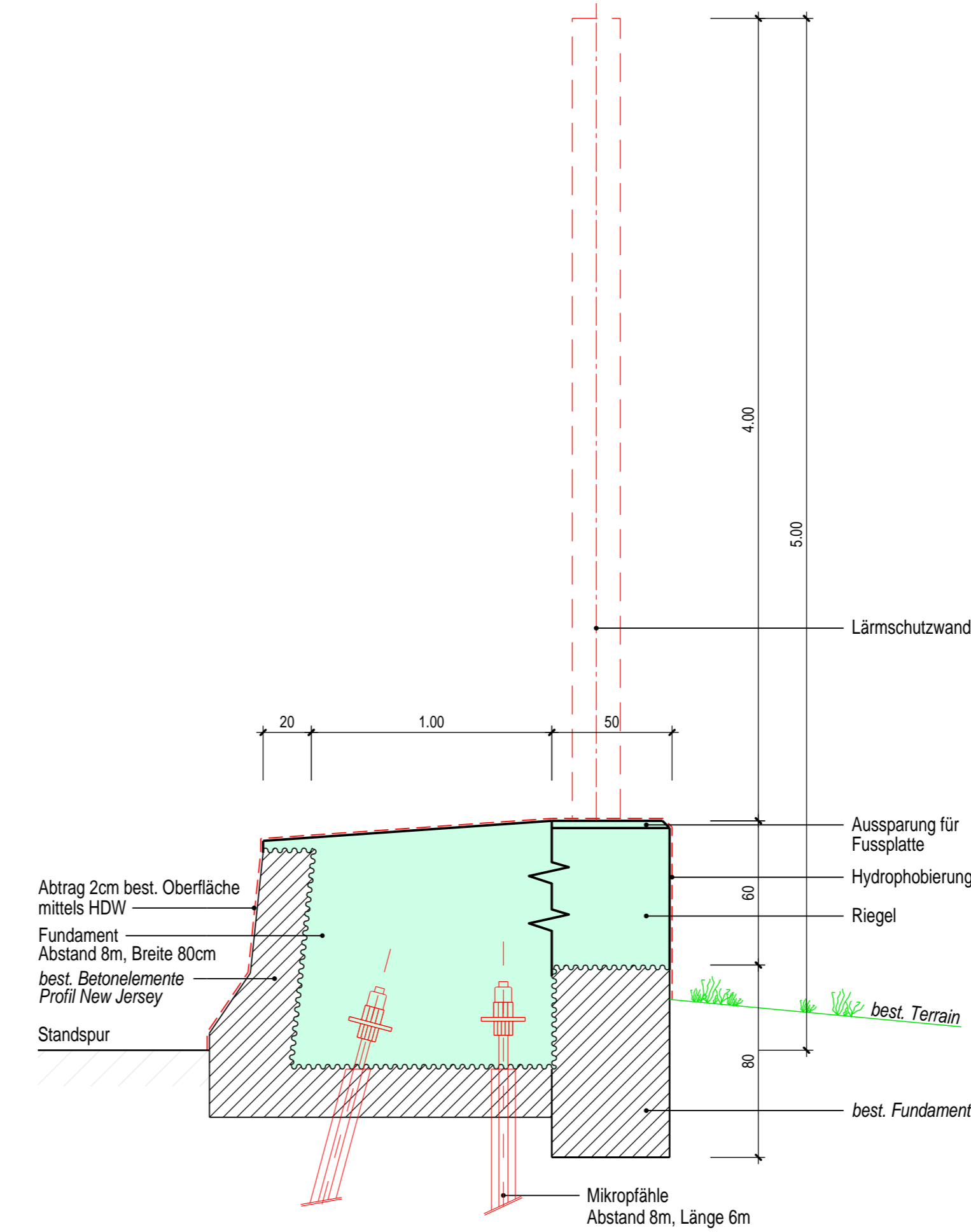

Querprofil 4 1:50

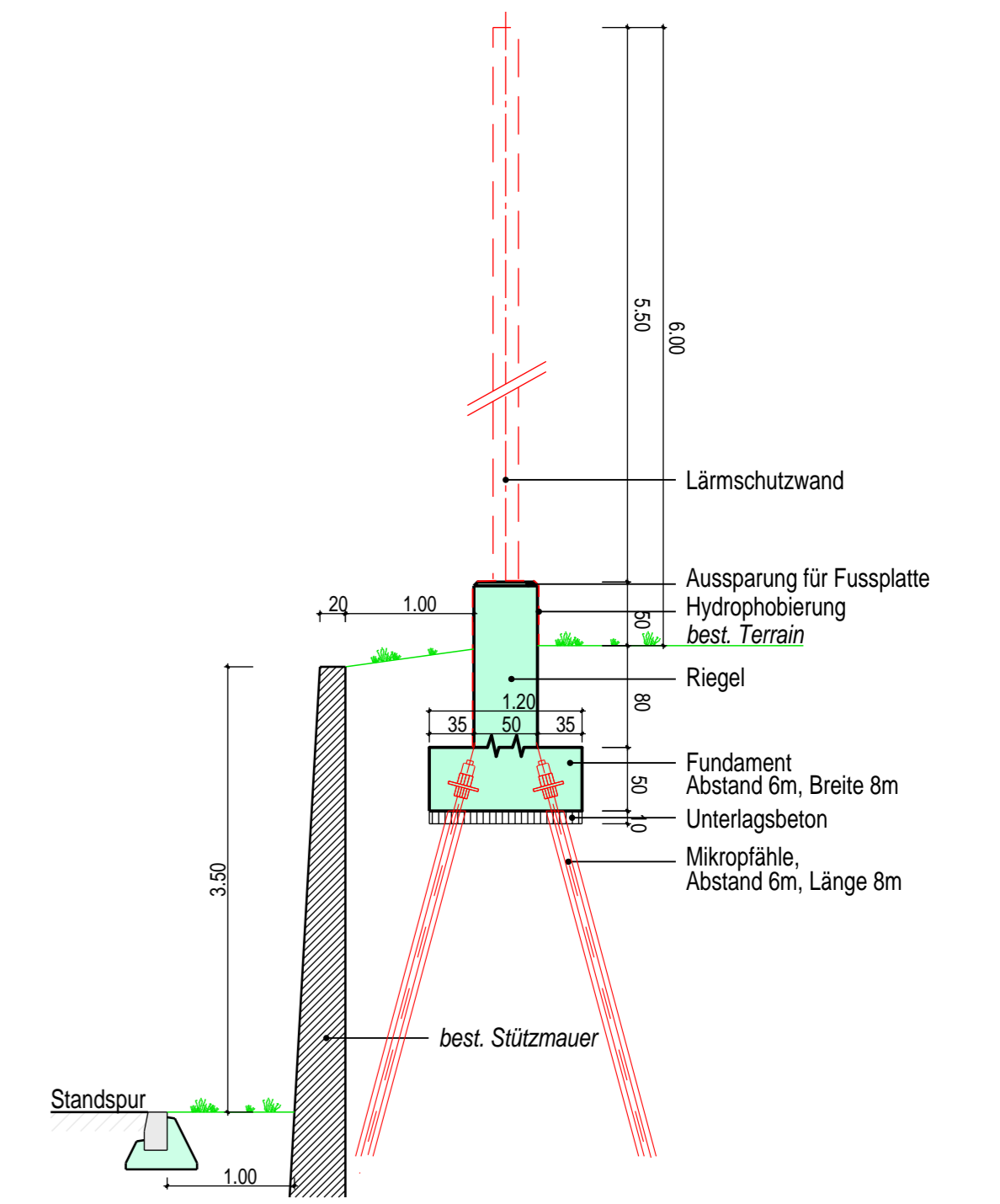

Querprofil 5 1:20

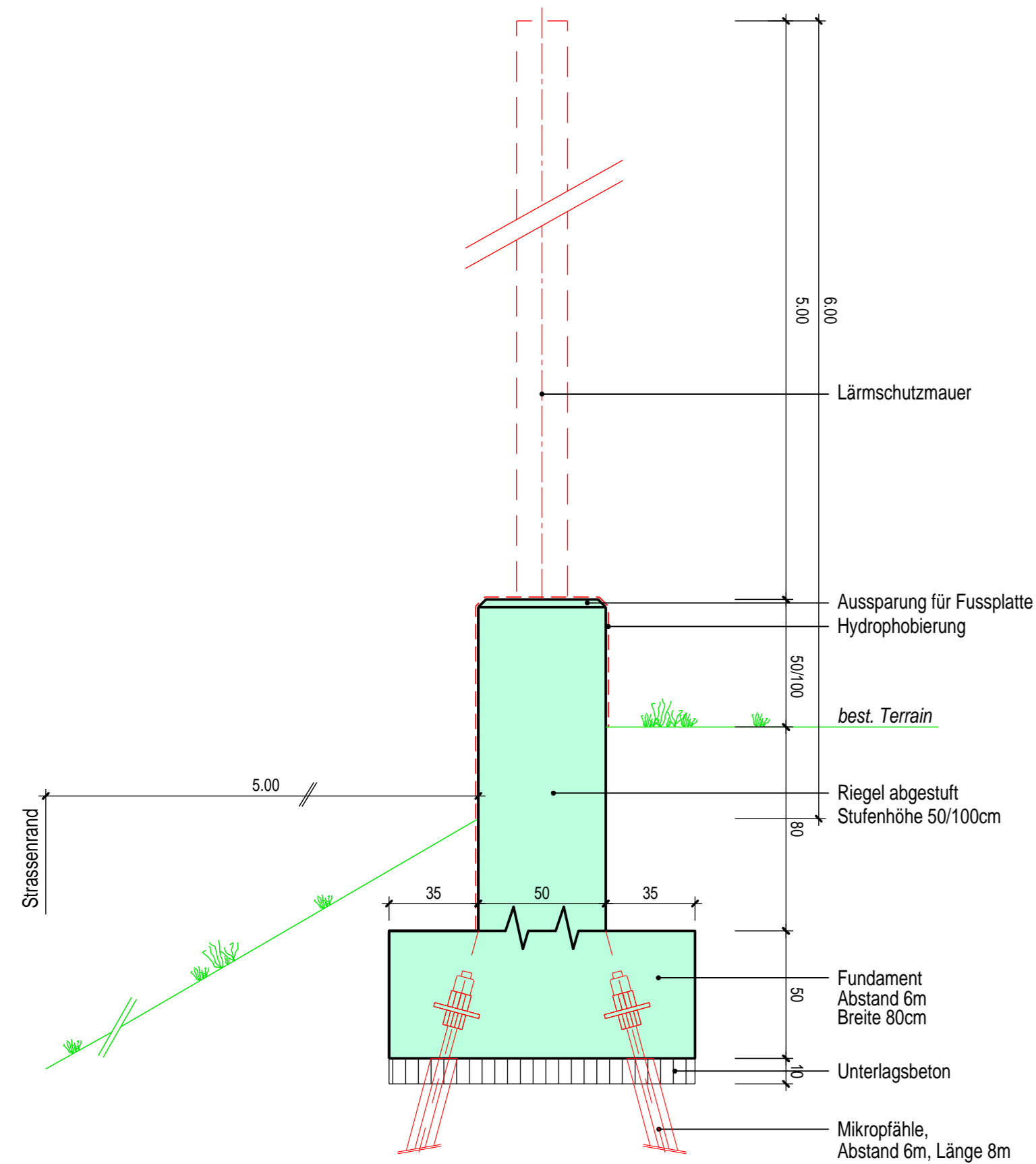

Querprofil 6 1:20

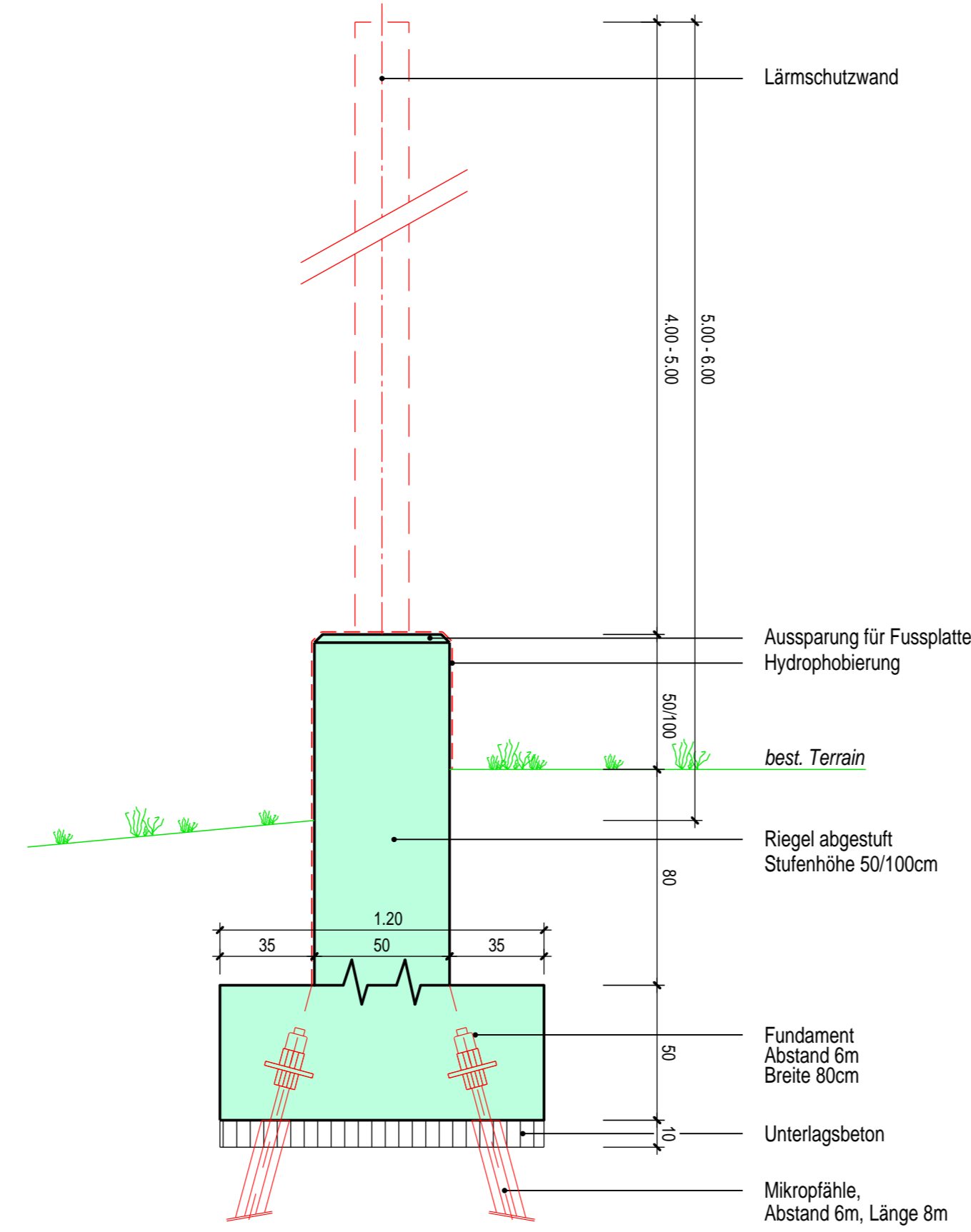

Querprofil 7 1:50

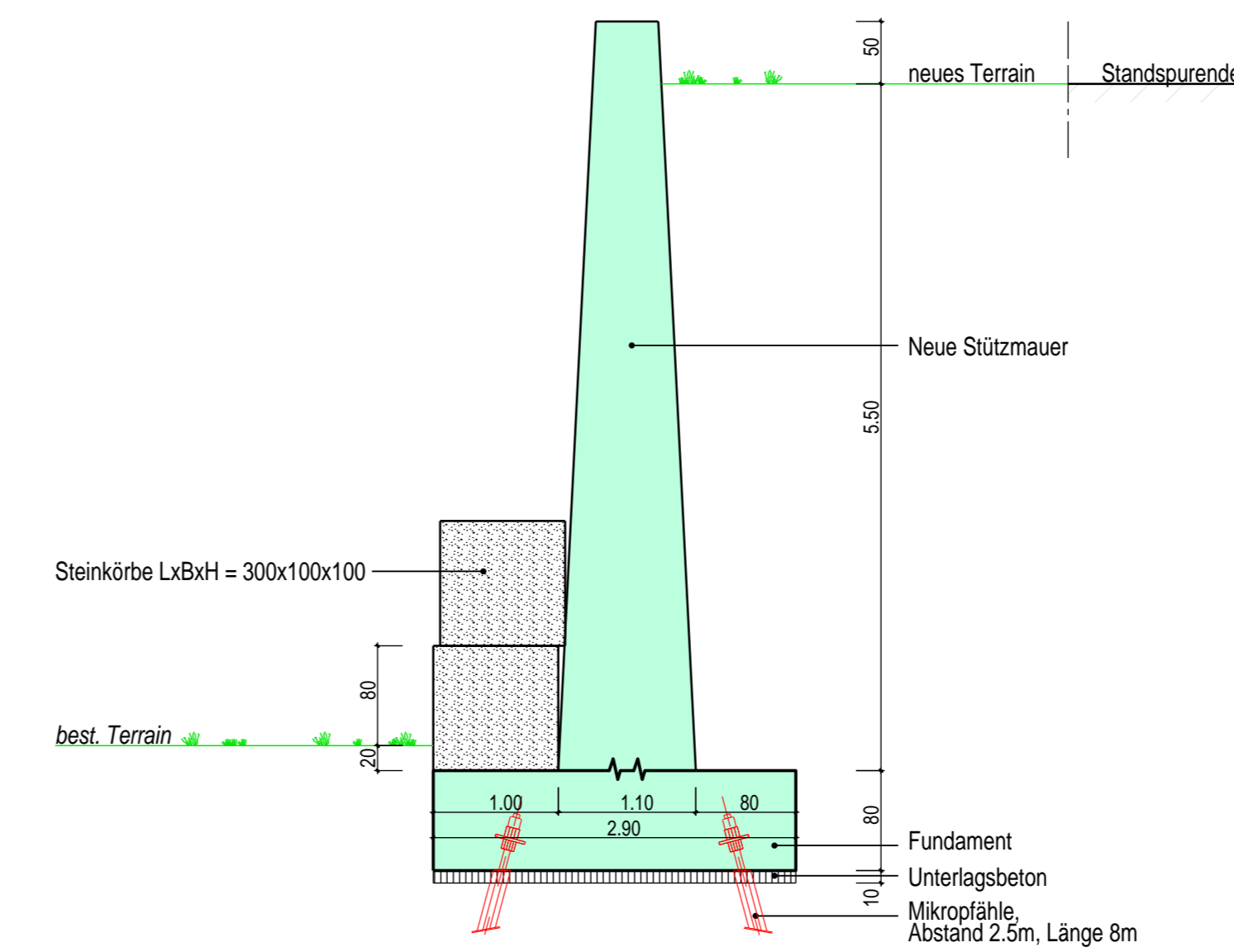

	Tiefbauamt Projektieren und Realisieren
Nationalstrasse N1 / N7 Abschnitt N1.1.4/5 Anschluss Ohringen - Kt. Grenze ZH/TG N7.2.1/2 Verzweigung N1/N7 - Kt. Grenze ZH/TG	
Unterabschnitt: Ohringen - Kantonsgrenze ZH / TG Objekt/Los: N1 Trassee Unterhaltsabschnitt: 48 Baukilometer: km 330.430 - 330.900 Polizeikilometer: Gemeinden: Wiesendangen / Winterthur	
<h2>Lärmschutz Ruchegg</h2> <p>Querprofile 1:20 / 1:50</p>	
Ingenieurgesellschaft BEB <small>via Basler & Hofmann, Ingenieure & Planer AG, Forchstrasse 395, 8032 Zürich, Tel. 044 387 11 22, Fax 044 387 11 00</small>	
Bürointerne Plan-Nr. EWP 615	
Rev.	A B C D Format
Datum 17.08.07	Massstab 1:20/50
Gez. Bet	Plot-Datum 13-09-07 CADWORK/14.0
Gepr. Bra	Auftrags-Nr. 1201 5008 400
Submission	
Bez-Code EI-Mech. TBA-Plan-Nr.	